

LUXURY MOBILE CAMP



Our Luxury Mobile Camps are all about an authentic safari experience, stripped of the unnecessary barriers to an intimate, exclusive wilderness, without sacrificing any comfort or convenience.

Step back in time to the days of the original safari pioneers. Where the fire crackles and you are surrounded by the wide-open expanse of the bush and the open night sky wraps around you. Hear the loud, thunderous sound of a lion's roar as you realize that there is nothing but the canvas of your tent and the crisp night air that separates you from the East Africa's top predator.

THE LUXURY MOBILE CAMP EXPERIENCE

- A traditional tented camp with home comforts.
- With a private team of staff to take care of every need – including a chef, tent attendant, waiters, the Mobile Camp is tailored to your needs. Your menu, drinks list, rooming and tent configuration can all be pre-planned with you.
- In the heart of the action – Kenya's most breath-taking landscapes on your door step, wildlife, remote areas and prime locations in the main safari destinations.
- On your own schedule – true flexibility with no restricted eating hours and no timed game drives.
- Explore areas well off the beaten track - our Luxury Mobile Camp has the ability to place you exactly where you want to be, at exactly the right time in order to experience the best wildlife.

- True exclusivity in the bush – the camp is just for you and your guests.
- Privately guided – your own private guide with you throughout your trip, recommending the best places to be for those truly memorable experiences
- Enjoy activities that each area has to offer, including day & night game drives, bush walks, village & school visits, in-depth interaction with the Maasai & Samburu communities, helicopter rides and much more.

LUXURY MOBILE CAMP AS PART OF A SAFARI

The Luxury Mobile Camp is set up at locations of your choice:

- A single destination.
- A camp set up in 2 or 3 locations stopping at permanent camps or lodges in between.
- Back to back camps – no need to use permanent camps or lodges, simply move from one Luxury Mobile Camp to another.

BRANDED FOR YOUR GROUP

- All of our camps are non-branded
- We are able to add your self branded items including:
 - Caps
 - T-shirts
 - Vehicle stickers
 - Brochures

CAMP CONFIGURATION

Camp sizes vary from 1 guest tent for 2 people up to a total of 24 people in 12 Luxury tents.

2 of these tents are 'Luxury Suites'.

- A Family Suite can be created by joining 2 Luxury Tents with a fully enclosed netting common area between the two rooms.

We have facilities to mobilise 2 camps in different parts of Kenya at once.

LUXURY GUEST TENTS

- All tents are made from heavy duty canvas & rip-stop with insect proof door and window linings
- Each has a verandah with a table and chairs.
- All tents have en-suite bathroom facilities
- All beds have cotton linen, duvets (comforters) and heavy blankets. A hot water bottles is provided in the evening.
- Additional furniture includes bedside tables, hanging caddy, luggage racks, hanging canvas shelves

BATHROOM FACILITIES

- Bathroom dresser table with in-built sink, warm water dispenser and vanity stool
- Flushing ceramic toilets
- Piping hot safari showers delivered at any time.
- Shampoo, conditioner, body lotion, vanity kit, sewing kit, shower cap.

LIGHTING AND POWER

- Solar powered lighting available 24hrs – verandah, bedside tables & overhead in the bedroom, shower, toilet and over the wash table.
- Hand held flash lights
- Reading light
- 240V charging facilities are available in the main lounge.
- Kerosene lanterns illuminate the paths at night and guests are escorted to and from their tents.

DINING AND LOUNGE

- Separate Dining and Lounge tents
- Breakfast and lunch are served in the dining area or al fresco under the shade of the trees.
- Picnic breakfast and/or lunch can be served out on game drives.
- Dinner is served around a large dining table, 'dining-party style' in the Dining tent or under the stars.
- Continental-style cuisine caters to a variety of dietary tastes and requirements.
- Menus can be agreed with you in advance.



ZONE 1 - GREATER MARA

Mara Conservancy (Mara Triangle):

- Location 1: Dirisha is on the Mara River
- Location 2: Kiboko on the Mara River
- Activities: Day game drives within the reserve, Maasai village-school-market visits (outside reserve).

Ole Derekesi Conservancy:

- Location: The Sand River, close to the boundary of the Maasai Mara Game Reserve.
- Activities: Day & night game drives in the Ole Derekesi Conservancy, day game drives into the Maasai Mara Game Reserve, guided bush walks, Maasai village-school-market visits and visiting conservancy projects.

Maasai Mara Game Reserve:

- Location 1: Various campsites in the 'Doublecross' area, along the Ntiakitiak and Olare Orok rivers, close to Emarti Hill, Rhino Ridge and the 'Topi Plains'.
- Location 2: Sand River 2km from Mara River bridge
- Activities: Day game drives within the reserve, Maasai village-school-market visit (outside reserve).

ZONE 2 - LAKE NAKURU, ABERDARES, SOLIO

Lake Nakuru National Park

- Location 1: Naishi - on the southern side of the lake, in a Fever Tree forest close to the Nakuru airstrip.
- Location 2: Reedbuck - on the souther-western side of the lake, in a Fever Tree forest, close to the western wall of the park
- Activities: Day game drives within the park.

Aberdares National Park

- Location 1: Prince Charles - a KWS special campsite set in the thick forests of the Salient.
- Other Locations: Other special campsites in the Salient include Muringato, Bongo, Nyati, Queen Beatrix, Kiguru and Kifaru.
- Activities: Day game drives within the park, Moorland walks, Chania Falls hike, fishing.

Solio Conservancy

- Location: Naribo Springs - a glade within an Acacia Fever Tree forest in the northern part of the conservancy.
- Activities: Day & night game drives within the Conservancy, day trips to Aberdares National Park, horse riding & walks (outside conservancy).

ZONE 3 - AMBOSELI & TSAVO

Amboseli - Kitenden Conservancy

- Location: Engumi - a seasonal stream valley lined with Tortilis trees, in the Kitenden elephant corridor close to the Tanzanian border.
- Activities: Day & night game drives within Kitenden Conservancy, day game drives into Amboseli National Park, bush walks, Likelesi Canyon hike, Maasai village-school-market visits, Moran manyatta visit.

Tsavo East National Park

- Location: Kanderi - 12km from Tsavo East main gate.
- Location 2: Tiva - various sites in the palm forests along the Tiva River.
- Activities: Day game drives within the park, walking safaris permitted in northern wilderness area (Tiva Campsites).

Tsavo West National Park

- Locations: Simba & Royal Little - on the banks of the Nolturesh stream, in the vicinity of Kitani Severin lodge.
- Activities: Day game drives within the park, Ngulia rhino sanctuary visit, Mzima Springs, Chaimu crater walk, Shetani lava flow & caves visit, Roaring Rocks.

ZONE 4 - LAIKIPIA, SAMBURU, BUFFALO SPRINGS & MERU

Ol Pejeta Conservancy:

- Location 1: Campi Punda - a dense Euclea thicket within the remote 'Wilderness Zone', with lovely views towards Mt Kenya.
- Location 2: Murera Donga - a secluded stand of trees overlooking a marsh, which attracts wildlife throughout the year.
- Activities: Day & night game drives within Ol Pejeta Conservancy, bush walks, Endangered Species enclosure, Chimpanzee Sanctuary & 'behind the scenes', tracker dogs, lion tracking, horse riding.

Buffalo Springs National Reserve:

- Location: Isiolo River - thickets of palms and acacia trees on a tributary of the Ewaso Nyiro River.
- Activities: Day game drives within reserve, Buffalo Springs swimming hole, Samburu village-school-market visits (outside reserve)

Samburu National Reserve:

- Location: Ewaso Nyiro River - a stand of Doum Palms on teh banks of the Ewaso Nyiro river.
- Activities: Day game drives within reserve, Samburu village-school-market visits (outside reserve)

West Gate Conservancy:

- Location: Belinda's Campsite - set along the Ewaso Nyiro river about 15km from the West Gate Conservancy HQ.
- Activities: Day & night game drives within West gate Conservancy, day trips into Samburu NP, bush walks, sundowner rock climbs, Ewaso Lions /Grevy's Zebra Trust project visits, Samburu village/school/market visits.

Meru National Park:

- Location 1: Kampi Baridi - along the Murera river, not too far from Murera Gate.
- Location 2: Rojewero - in riverine forest along the park's largest stream, the Rojewero River
- Activities: Day game drives, rhino sanctuary visits.

Borana Ranch (low season only):

- Location: Ngare Ndare River Exclusions Zone, onthe border with Lewa Conservancy.
- Activities: Day & night game drives within Borana Conservancy, bush walks, horse riding, ranching activities, mountain biking, lion & rhino tracking, Ngare Ndare Forest Reserve day trip (aerial walkway & waterfall hike), Lewa Conservancy day trip (HQ visit, tracker dogs, community projects).

TENT LAYOUTS & DIMENSIONS

LUXURY MOBILE CAMP: TENT LAYOUT

Luxury Tent Sleeps: 2 Adults
 Beds: 1 queen-sized bed OR 2 twin beds



Tent Dimensions

Overall tent dimension: 21ft x 12ft
Bedroom: 13 x 12ft
Bathroom: 8 x 12ft
Verandah: 6 x 12ft

Wall height: 7ft
Tent Height: 9ft

LUXURY MOBILE CAMP: TENT LAYOUT

Luxury Suite/Triple Sleeps: 3 Adults as a triple OR 2 adults and 1 child
Main room: 1 queen-sized bed OR 2 twin beds
Second room: 1 single bed OR used as a lounge area



Tent Dimensions

Overall dimension:	27 x 11ft	Verandah:	6 x 12ft
Main Bedroom:	13 x 12ft	Wall height:	7ft
Bedroom 2:	6 x 12ft	Tent Height:	9ft
Bathroom:	8 x 12ft		

LUXURY MOBILE CAMP: TENT LAYOUT

Luxury Family Tent Sleeps: 2 Adults and 2 children
 Beds: Both rooms - 1 queen-sized bed OR 2 twin beds
 Lounge: Enclosed netted central area

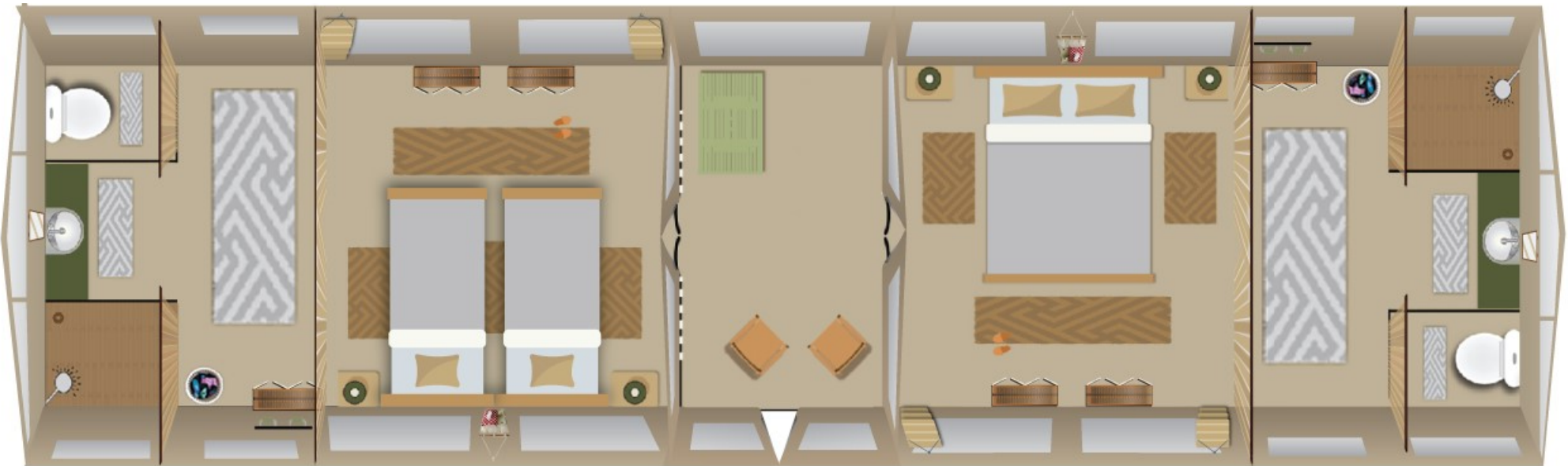

Tent Dimensions

Overall dimension:	52 x 12ft	Central area:	10 x 12ft
Main Bedrooms:	13 x 12ft	Wall height:	7ft
Bathrooms:	8 x 12ft	Tent Height:	9ft

Visit our Dropbox to view and download images

For further information please contact:

marketing@eastafricasafariventures.com

+254 (0)729 483777 (Gillian Charleson)

+254 (0)702 338909 (Joe Charleson)

For a quotation please contact your local operator or our Sales Team:

safari@eastafricasafariventures.com

Mobile: +254 722 315159

East Africa Safari Ventures

P.O. Box 1629, 00502, Kenya

www.eastafricasafariventures.com

